



**HENRY  
KENDALL  
GROUP**

# Tuggerah Straight Commercial Centre

Hybrid workspaces available

- Team spaces from 4-50 seats
- Meeting rooms, breakout areas
- Fully serviced
- No long-term lease requirement

## Reduce floorspace and provide a flexible workspace for your team or business

The COVID-19 pandemic has accelerated a growing requirement for flexible working arrangements. Many businesses no longer want to maintain floorspace for their entire workforce.

Following up on the success of its Nexus Smart Hub - the first co-working hub in the region, the Henry Kendall Group will be redesigning the Tuggerah Commercial Centre to cater for businesses or remote teams requiring private suites complete with meeting rooms and breakout spaces. The site has easy access via Tuggerah Straight with ample parking.

Located above the retail precinct featuring national brands such as SUPACHEAP AUTO and BCF, the first floor suites can be configured to meet our tenant's requirements.

- Create your own team space
- Alternate usage days between teams
- Pay only for what you use
- Scale up and down as required
- No facilities management headaches
- Common areas and meeting rooms
- Ample free parking and transport

Artist impression of office fitout

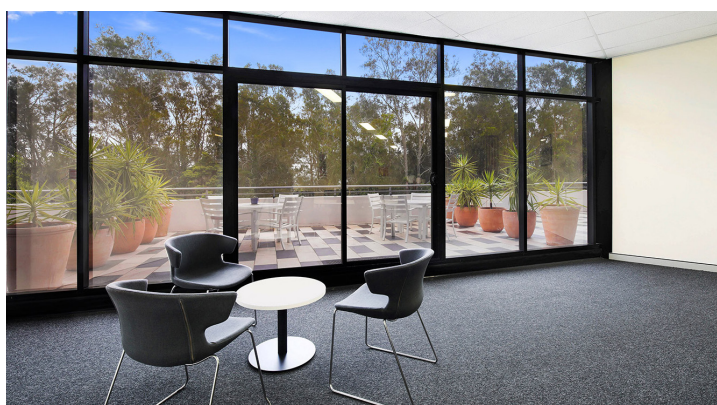

**HENRY  
KENDALL  
GROUP**

The Tuggerah Straight Commercial Centre is developed by the Henry Kendall Group.  
3 Amy Close North Wyong NSW 2259.  
For enquiries call 02 4355 5111

**CHAPMAN  
& FRAZER**  
COMMERCIAL REAL ESTATE  
For enquiries call 02 4325 0208